

iGET
HOMEGUARD

Super HD SmartCam Pro

Quick Start Guide - EN



Model: HGWBC-358

HGWBC-358



5 060442 173583

iGET HOMEGUARD 2022

✉ www.iget.eu/cs/helpdesk-centrum-cs

🌐 <https://helpdesk.intelek.cz>



Made in China

What's included



Battery Camera



Quick Start Guide

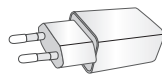

Power Adapter

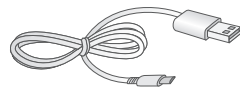

USB cable



Warning Stickers

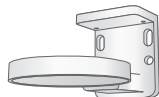

Bracket

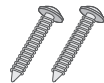

Fixings

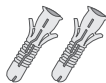

Wall Plug

Parts & Description



Front view

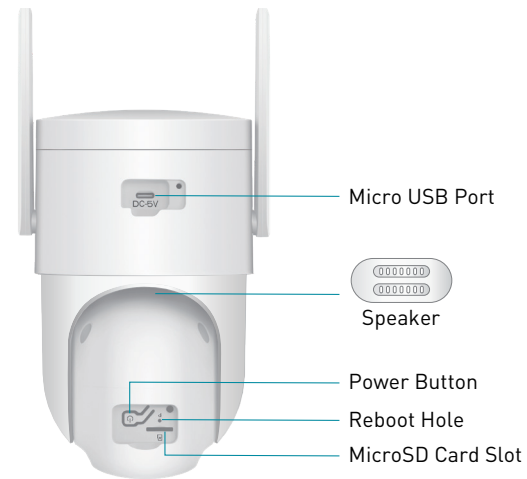





Back view

Battery Management

- 1 Battery life up to **6 months** base on an average of 200 seconds of recording footage per day
- 2 Charger Standard: **DC 5V 1.5A**.
- 3 It takes **8 hours** to fully charge it. Please fully charge the camera before first use.
- 4 The battery durability depends on how frequently the camera is woken up. The more times the camera is woken up, the faster the battery drains. It is recommended to lower down the '**Motion Detection**' sensitivity or turn it off occasionally.
- 5 The battery of your camera may drain faster below 32°F(0°C). When you receive low-battery alert on your app, it is suggested to take the camera down and fully recharge it indoor, or you can connect it to the power cable all the time.

Indicator Light Status:

Light	Mode	Device Status
	Working mode	Blue
	Sleep mode	Off
	Charging mode	Yellow
	Fully charged	Green

* Battery life varies based on settings, usage & temperature.

Charge the Camera Battery

- 1 Place the camera indoors. If you are using the camera outdoors, bring it inside while charging the battery.
- 2 Connect the power adapter cable to the camera power adapter. You must use the power adapter and cable that came with the camera.
- 3 Connect the other end of the adapter cable to the camera
- 4 Plug the power adapter into an electrical outlet.

* The rechargeable battery is 60% charged when it leaves the factory.

You can fully charge the battery before camera installation.

* The camera LED lights solid green when the camera battery is fully charged.



Step 1 Get the App

For the best experience, download the **Homeguardsmart** app for your smartphone by scanning the QR code below or searching for "Homeguardsmart" in the app store.

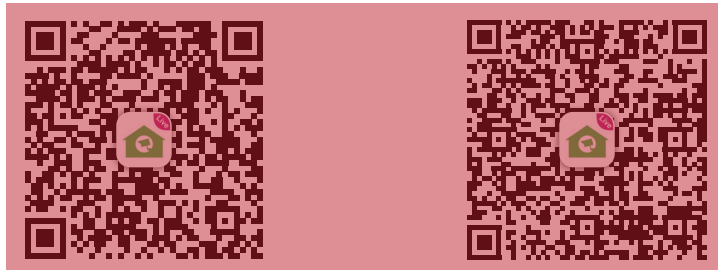

Step 2 Account Register

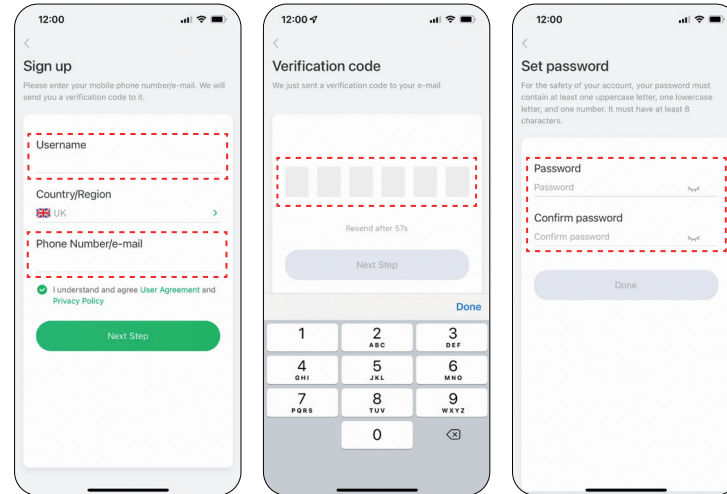

- 1 Open **Homeguardsmart** App, then select Sign up.
- 2 You will receive a verification code to your registered mobile phone or e-mail.
- 3 Create a password at least 8 characters long. Your password must include three of the following:
 - At least one uppercase letter
 - At least one lowercase letter
 - At least one number
- 4 Set up a password and write down as record: _____

Step 3 Add Device

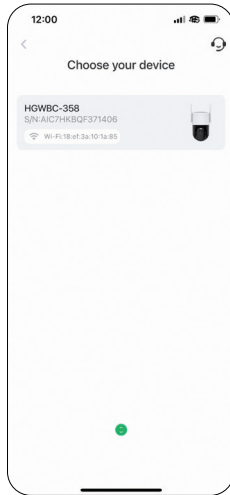
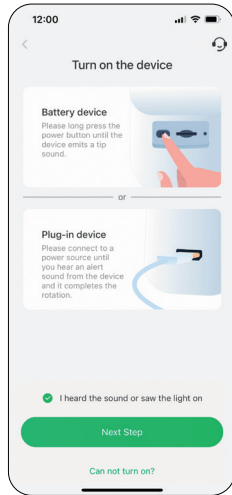
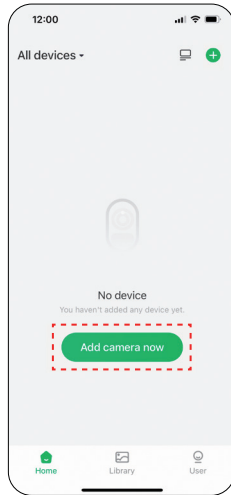

- 1 Login your account and tap **“Add camera now”**.
- 2 Press the power button until you hear scanning sound and see the light on.
- 3 Choose your camera and Connect to 2.4GHz Wi-Fi.

**If you can't hear 'Ding Dong Ding Dong', please double-click the power button to enter the network configuration mode again.*



Step 4 Connect to Network

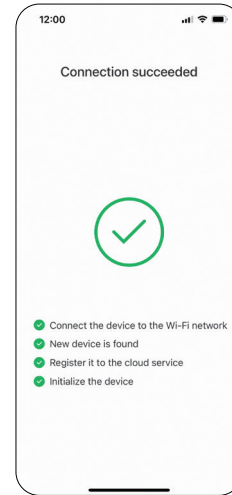
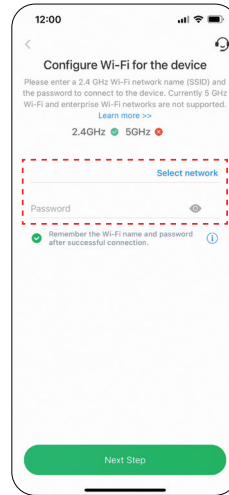

- 1 Enter the correct Wi-Fi password.
Note: The camera is not support 5GHz Wi-Fi.
- 2 This App will generate a QR code, place the QR code **6~12 inches(15-30cm)** in front of the camera lens. After scan the QR code, the camera prompt **“Wi-Fi connected”**.
- 3 Name the camera after the Pairing is successful.



You're Done!

Congratulations! Your HOMETECH Smart Camera is set up and ready to go.

You are now free to position your camera anywhere in your home where you get a Wi-Fi signal and view it remotely from anywhere in the world on your Smartphone or Tablet!

Home Page

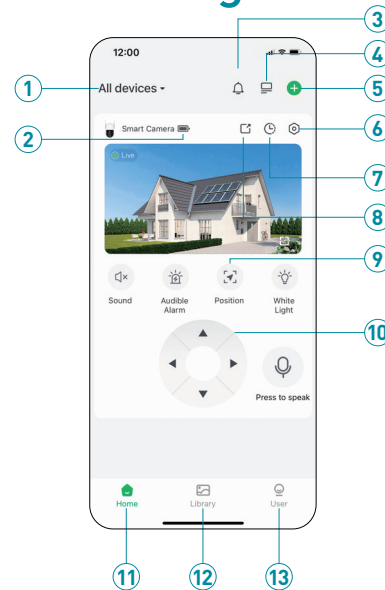

①	Device name	Select the camera
②	Battery Status	Check battery status
③	Undisturb	Do not disturb mode
④	Split-screen	Tap to access Split-screen view
⑤	Add Device	Tap to add a new camera
⑥	Setting	Tap to access camera setting
⑦	Replay	Tap to go into history playback list
⑧	Share	Share camera to family
⑨	Position	Tap to set your frequently watched positions
⑩	Rotate	Tap to rotate the camera to different direction
⑪	Home	Tap to access home page
⑫	Library	Tap to go into history playback list
⑬	User	Tap to access account information page

Live View

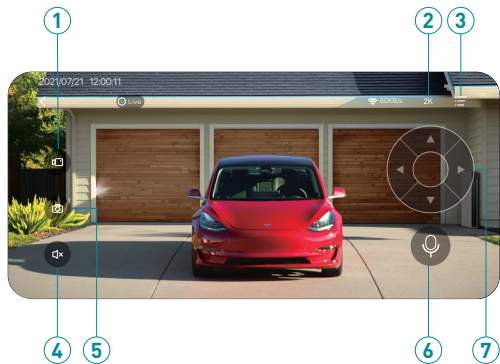

- | | | |
|---|----------------------|---|
| 1 | Record | Saves video clip from a live video |
| 2 | Resolution | Tap to change between video quality levels: SD, FHD |
| 3 | Setting | Tap to access camera setting, alarm & light setting |
| 4 | Mute / Unmute | Tap to hear the camera or unmute |
| 5 | Capture | Saves images captured from a live video |
| 6 | 2-way talk | Activate the microphone to enable 2-way talk |
| 7 | Rotate | Tap to rotate the camera to different direction |

PIR Motion Detection

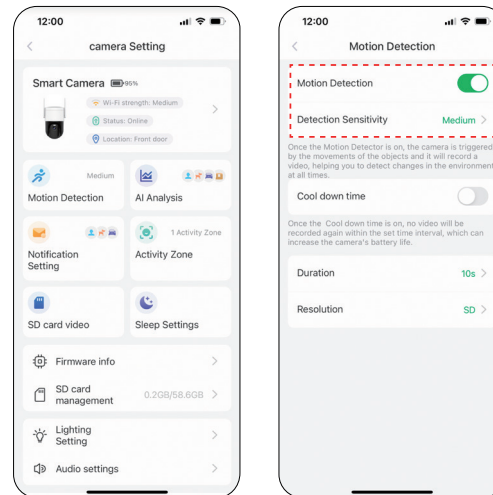

- 1 Turn on '**Motion Detection**' and adjust sensitivity.
- 2 When you turn on '**Alarm Siren**' (In Sound Setting) or '**Alarm Flash**' (In Lighting Setting), the camera will sound an alarm or keep flashing when motion detected.

AI Analysis & Notification

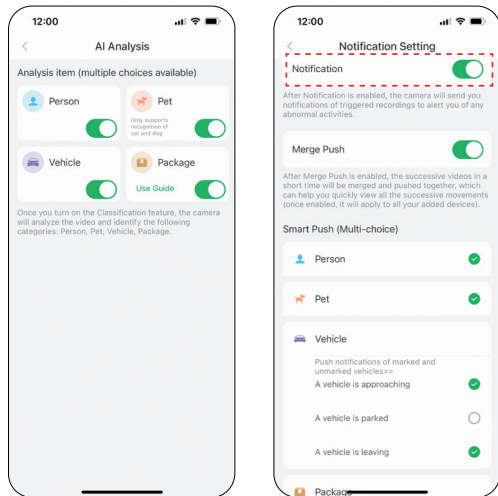

- 1 Before turn on '**Notification**', please first turn on '**Motion Detection**' to receive alarm messages.
- 2 The AI Analysis can tell the difference between people, vehicles, pets and packages.
- 3 You can set up notification base on Person, Pet, Vehicle & Package.

Activity Zone

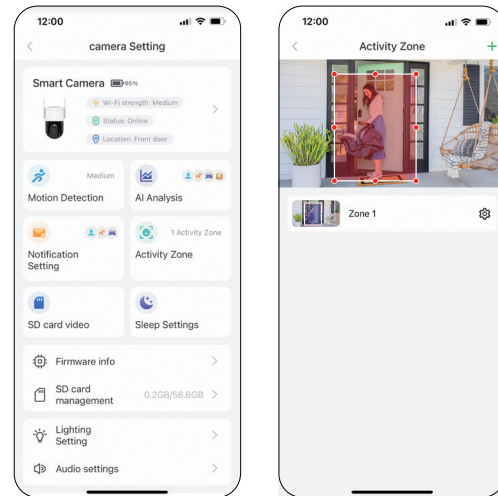

- 1 All videos will still be recorded after setting activity zones, but you will only receive notification of movements in your activity zone.
- 2 The principle of Activity Zone is to judge the objects activity in pointed area with combining intellegent analyse on cloud. Therefore it's a cloud-based AI.

Night Mode

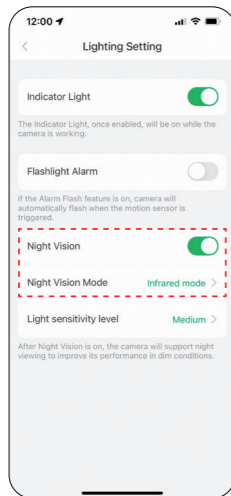

- 1 **'Infrared mode'** is a black and white view under night vision; **'White light mode'** is a color view under night vision.
- 2 **'White light mode'** will turn on the spotlight at night and capture a colorful view. The spotlight will be constantly on when there is a motion detected or when living view.

Filter Video

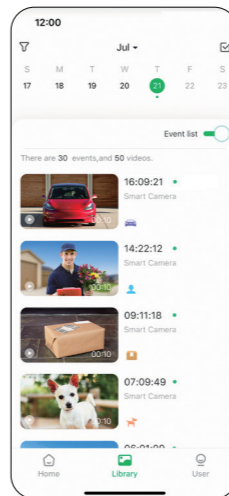
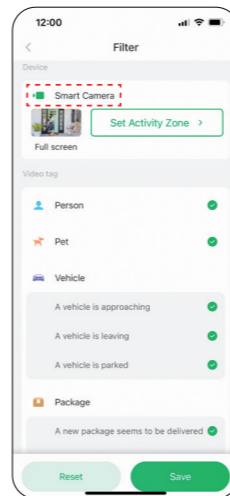

- 1 Select videos by camera names, tags and others.

Share Camera

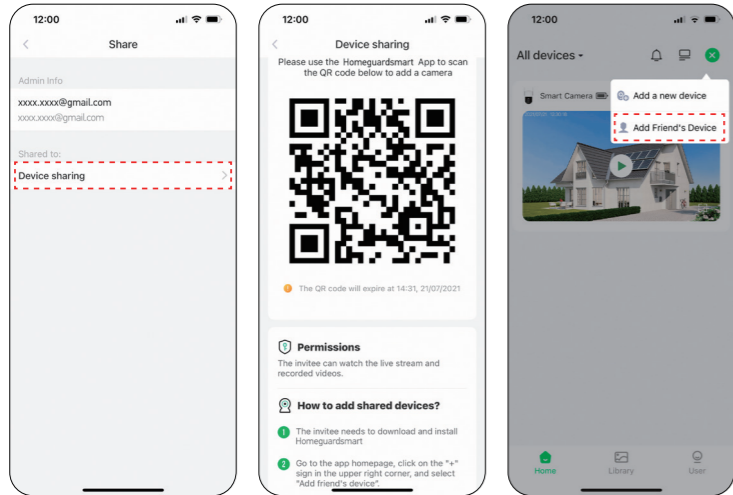

- 1 Click "**Device sharing**", and a QR code will be generated for sharing.
- 2 Enters the '**Home**' page and click '**Add Friend's Camera**', then scan QR code. After you accepts sharing, sharing is complete!

Multi-Device Management

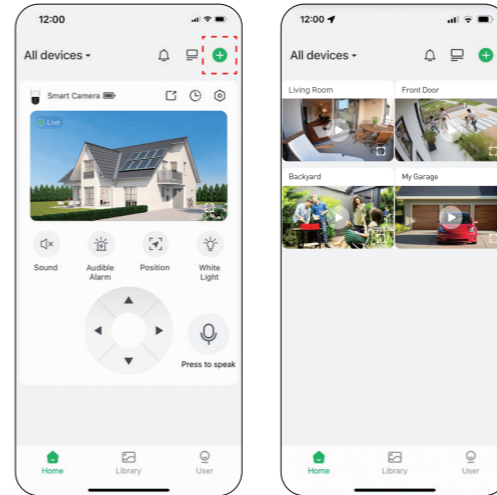

- 1 Click '+' to add more devices
- 2 Split screen setting can watch live broadcast from multiple cameras at the same time
**Strong Wi-Fi Connection View Multiple Cameras at the Same time*

Camera Reset

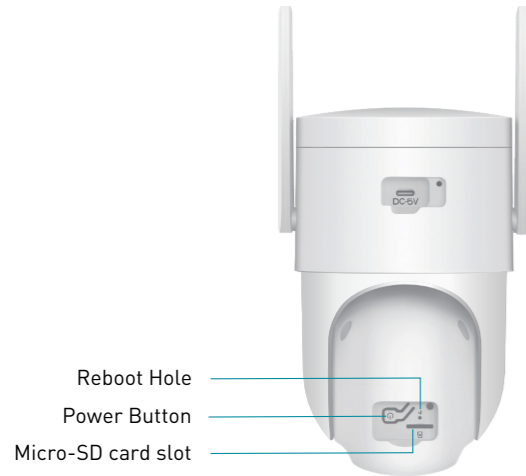

- 1 Press the 'P' hole with a pin to reboot camera.
- 2 Double-click the camera power button to reset the camera and enter connection mode again.

Files Storage

Micro SD Card

- 1 Remove the rubber plug at the bottom of the camera.
- 2 Insert the Micro SD card and wait a few seconds until you hear '**SD card detected**', or you can check if the Micro SD card is inserted successfully in '**Advanced Setting**' (If not, try it again after turning off the camera).

Cloud Recording

- 1 Provide free 3 days rolling cloud storage.
- 2 Provide Free 30 days Secure Plan.

Free 30Days Secure Plan Included:

	Without Plan	
Super HD Cloud Video History		30Days
Live Video Streaming	✓	✓
Local Storage*	✓	✓
Motion Alerts	✓	✓
Rich Notifications		✓
Advanced Object Detetion		✓
Custom Activity Zones		✓
AI Analysis [people , pets , vehicles , packages]		✓

* Requires paid subscription after trial period

Place or mount your cameras

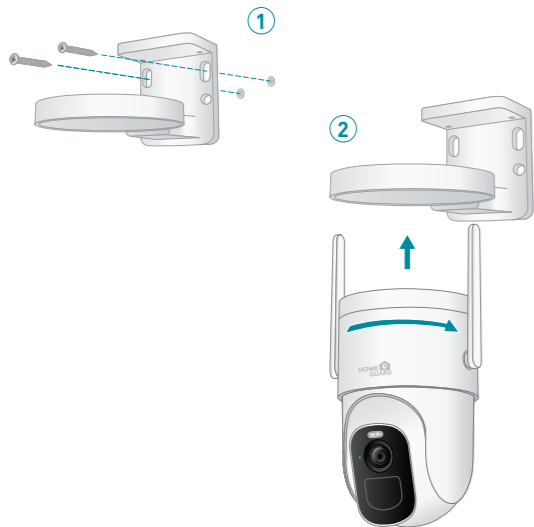

You can mount your camera on a wall or ceiling. Place your camera in a location with a clear, unblocked field of view and with a good Wi-Fi signal.

- 1 Place the wall mount against the wall, with the arrow pointing up, and secure it with screws.

Note: If you are mounting the camera on drywall, we recommend using the included wall anchors.

- 2 Attach the camera to the mount.

- 3 Mount your camera at least 7 feet (2 meters) above the floor or the ground and aim it slightly downward for the best sensor performance. Place your camera so that side-to-side traffic crosses its field of view. The motion sensor is most sensitive to side-to-side motion that's 5 to 20 feet (1.5 to 6 meters) from the camera

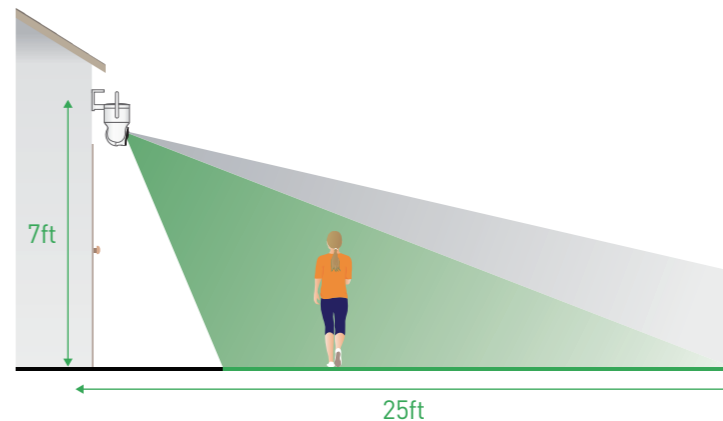

FAQ

Q:What should I do if my camera doesn't work?

- A: 1. Please open the rubber plug on the camera bottom, find the 'P' hole, insert a pin&press it for more than 5s to reboot the camera.
2. Double-click the camera power button to reset the camera and add it again.

Q: What should I do if I cannot connect to the camera?

- A: 1. Make sure the camera is power enough and turned on.
2. Make sure your Wi-Fi router is 2.4GHz instead of 5GHz.
3. Make sure to enter the correct Wi-Fi name and password.
4. Take camera and phone close to your router to ensure strong signal.
5. Go to 'Home' page and click '+'. Click 'Add a new camera' and follow the steps till done.

Q: What if I did not receive motion detection notification?

- A: 1. Go to 'Setting' page of your phone -> Notification -> Homeguardsmart App -> turn on 'Notification'.
2. Go to 'Home' page of App -> Setting -> Notification -> turn on ' Notification'.
3. Make sure to turn on the 'Motion Detection' function of the camera in App.
4. Reboot your internet router and make sure a strong Wi-Fi signal. Add your camera to your phone again in App.

FAQ

Q: Why doesn't the Wi-Fi name appear when I connect to Wi-Fi?

- A: On Apple devices with iOS13 and above, you need to turn on the "location permission" for the app in the system settings and change it to "allow when using."

Q: How far should the camera be placed from the router?

- A: After testing, the Wi-Fi connection distance can normally reach up to 220 meters in the open area. However, the actual situation depends on the strength of Wi-Fi and its surrounding environment (thick walls, electromagnetic devices, large metal objects will all cause interference to the Wi-Fi signals). If the camera connection signal is weak or unstable, please place the camera as close to the router as possible.

Q: What is the longest time for the camera to record an alarm video?

- A: 1. It records 3 minutes maximum under 'Auto' mode.
2. If you want each video to be 10s, 15s or 20s, you can set it in App

Q: How to quickly view videos by category?

- A: Click the icon in the upper left corner of the "Library" page to start filtering videos by category. Select the category you want to see and then click "Save" to view the video playbacks.

FAQ

Q: What if the SD card cannot be detected?

- A: 1. It must be a Micro SD card; at least 10 MB/S can be used (For a MicroSD card 64GB, 128G, 30 MB/S is recommended).
2. Insert the SD card to your camera when it is power on. You will hear 'SD card detected'. If no voice reminding, please turn off your camera and then insert the card again. Then turn on the camera and check the SD card status in App.
 3. If it still cannot be detected, try formatting the SD card and reinsert.
 4. Try to use another SD card and see if it works well.

Q: Why does the camera battery drain fast?

- A: 1. The longer the camera works, the faster the battery drains. Therefore, we suggest, if it's possible, reduce the sensitivity of motion detection, the time of two-way calls and watching live.
2. If you receive too many alarm notifications, please adjust the sensitivity from 'High' to 'Low' to reduce the number of alarms, or set the 'Activity Zone' to narrow the detection range.
 3. You can adjust the installation angle of the camera to avoid unnecessary alarms, to save battery power. For example, don't let the camera face a sparkling swimming pool, swaying trees, or heavy traffic, etc.
 4. As you may know, battery drains faster in cold environment.

Specifications

Item	Description
Image Sensor	1/2.8" Progressive Scan CMOS
Viewing Angle	120° Wide Angle
Pan/Tilt Range	Horizontal 360°, Vertical 100°
Battery Life	Up to 6 Months
Power Source	Rechargeable 9000 mAh Lithium Battery
Weatherproof	IP66 Rated
Color Night Vision	Up to 43ft/13m
AI Function	Human/Vehicle/Pet/Package Detection
Video Quality	Super HD 3MP (2304 × 1296 pixels)
Frame Rate	Max 15 fps
Video Compression	H.265
Siren	90 dB+
Two-way Talk	Microphone & Speaker
Smart Alert	Yes
Battery Recharging	Micro USB Cable
Operating Temp	-10 °C - 45 °C
Operating Power	DC 5V / 1.5A, < 2.23W
Dimensions & Weight	120 × 101 × 158 mm, 600g
Storage Options	MicroSD Card Up to 128GB&Cloud Recording Storage
Warranty	24 Months

